



# Delta/PRO Spray Packages Low Pressure Spray Finishing

PACKAGES

- Corrosion resistant/SST construction
- Fully assembled and tested
- Wide variety of mounting configurations available
- All packages include the revolutionary Delta spray AS/HVLP guns or PRO 3500/4500 guns

**Package solutions for low pressure spray applications**

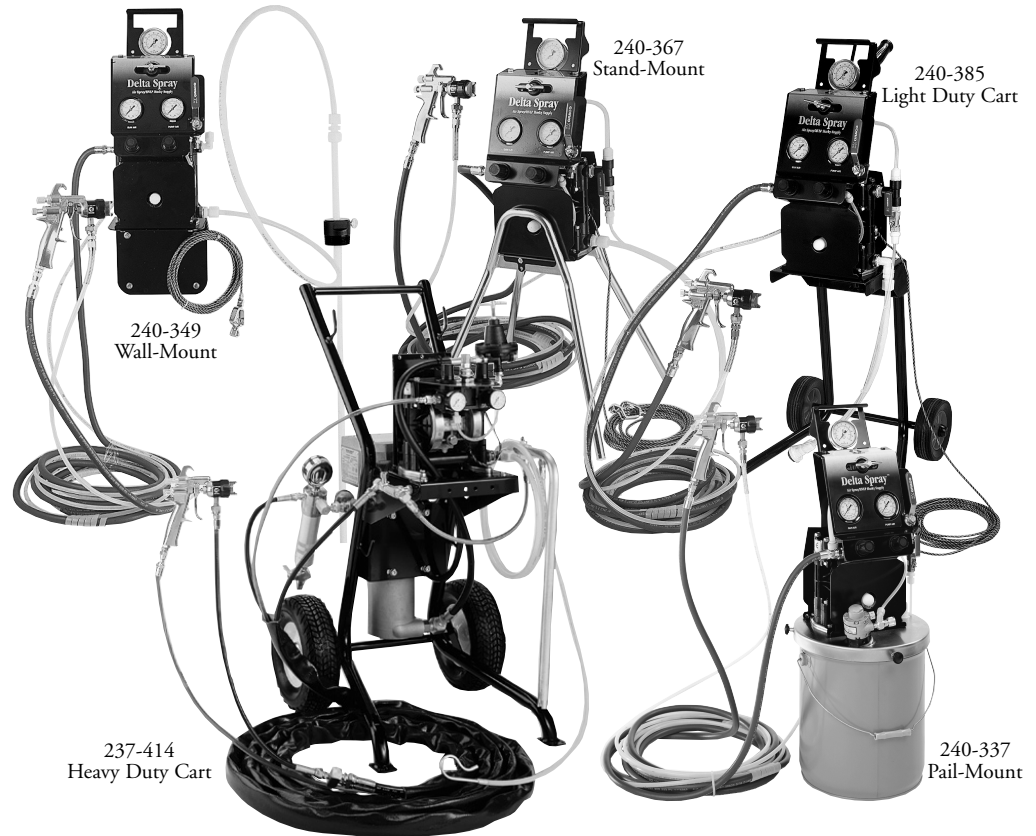

Graco's complete package solutions are matched to your application needs, for high performance and durability. Packages are available for most of today's material requirements. Unique modular designs make these packages easy to use and maintain. They are fully assembled, tested and ready to use, including spray gun and hoses.

These sprayers combine proven Graco Husky 307™ diaphragm pump technology with the revolutionary Delta spray AS/HVLP gun or the PRO 3500/4500 gun. You'll experience high performance and trouble-free reliability with Graco spray package solutions.

### Typical Fluids Handled

- Epoxies
- Polyurethanes
- Enamels
- Alkyds
- Lacquers
- Stains

### Typical Applications

- Furniture/wood
- Aerospace
- Fleet
- Farm & construction equipment
- General metal fabrication

# Technical Specifications

- Maximum working pressure . . . . 100 psi (0.7 MPa, 7 bar)
- Maximum air input pressure . . . . 100 psi (0.7 MPa, 7 bar)
- Maximum fluid flow (pump) . . . . . 6.5 gpm (24.6 lpm)
- Maximum pump speed . . . . . 330 cpm
- Maximum suction lift . . . . 7 ft (2.1 m) dry; 12 ft (3.7 m) wet
- Air Inlet Size . . . . . 3/8 npsm
- Air Outlet Size . . . . . 1/4 npsm
- Fluid Inlet Size . . . . . 3/8 npt(f)
- Fluid Outlet Size . . . . . 3/8 npt(f)
- Gun air consumption . . . . . 16 scfm at 50 psi  
(0.45 m<sup>3</sup>/min at 0.35 MPa, 3.5 bar)

**Pump air consumption at free flow** 5.5 scfm (0.15 m<sup>3</sup>/min)

**Wetted parts:**

- Pump** . . . . . polypropylene, acetal, stainless steel, Teflon®
- Spray gun** . . . . . 303/420 stainless steel
- Pail cover** . . . . . stainless steel
- Fluid hose and tubing** . . . . . nylon
- Fluid fittings** . . . . . nylon, acetal, 304/316 stainless steel
- Fluid regulator** . . . . . acetal resins, Teflon®, tungsten carbide,  
304/316/17-4 pH stainless steel

**Weight (includes hose and gun)**

**Pail-Mounted Packages**

- with fluid pressure regulator . . . . . 29 lb (13 kg)
- with fluid surge tank . . . . . 29.5 lb (13.5 kg)
- with regulator and agitator . . . . . 32 lb (15 kg)
- with surge tank and agitator . . . . . 30.5 lb (14 kg)

**Wall-Mounted Packages**

- with fluid pressure regulator . . . . . 29 lb (13 kg)
- with surge tank . . . . . 27 lb (12 kg)

**Stand-Mounted Packages**

- with fluid pressure regulator . . . . . 30 lb (14 kg)
- with surge tank . . . . . 28 lb (12.5 kg)

**Light Duty Cart-Mounted Packages**

- with fluid pressure regulator . . . . . 38 lb (17 kg)
- with surge tank . . . . . 36 lb (16 kg)

**Instruction manuals**

- Pail Mounted Packages . . . . . 308-822
- Wall Mounted Packages . . . . . 308-845
- Stand Mounted Packages . . . . . 308-846
- Light Duty Cart Packages . . . . . 308-821
- Heavy Duty Heated Cart Pkgs . . . 308-448, 308-451, 308-454

# Performance Charts for Husky 307 Pumps

## Fluid Flow

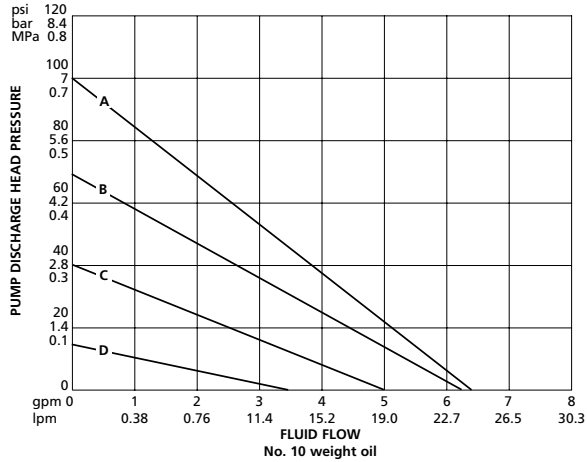

## Air Consumption

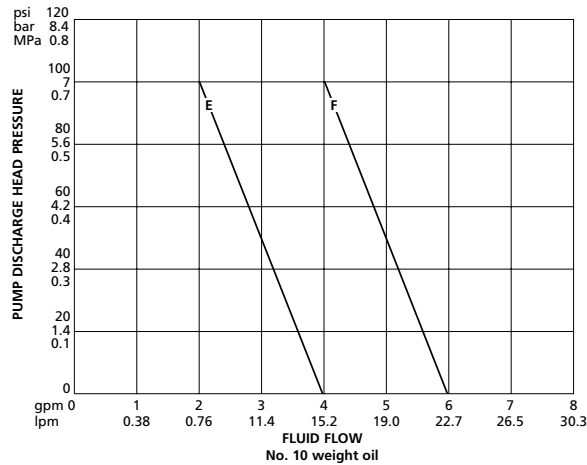

**Fluid Outlet Pressures**

- A = 100 psi (0.7 MPa, 7 bar)
- B = 70 psi (0.5 MPa, 4.9 bar)
- C = 40 psi (0.3 MPa, 2.8 bar)
- D = 20 psi (0.1 MPa, 1.4 bar)

**Air Consumption**

- E = 3 scfm (0.084 m<sup>3</sup>/min)
- F = 5 scfm (0.14 m<sup>3</sup>/min)

# Dimensions

## Light Duty Cart-Mounted Package

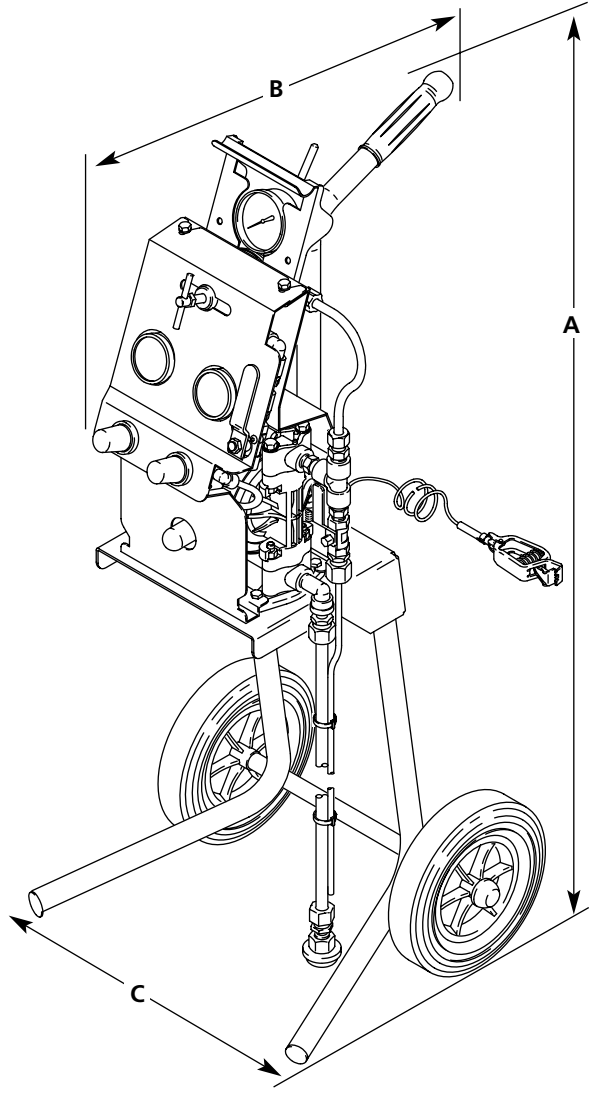

A Height	B Depth	C Width
39.1 in. (993 mm)	18.0 in. (457 mm)	16.8 in. (427 mm)

## Stand-Mounted Package

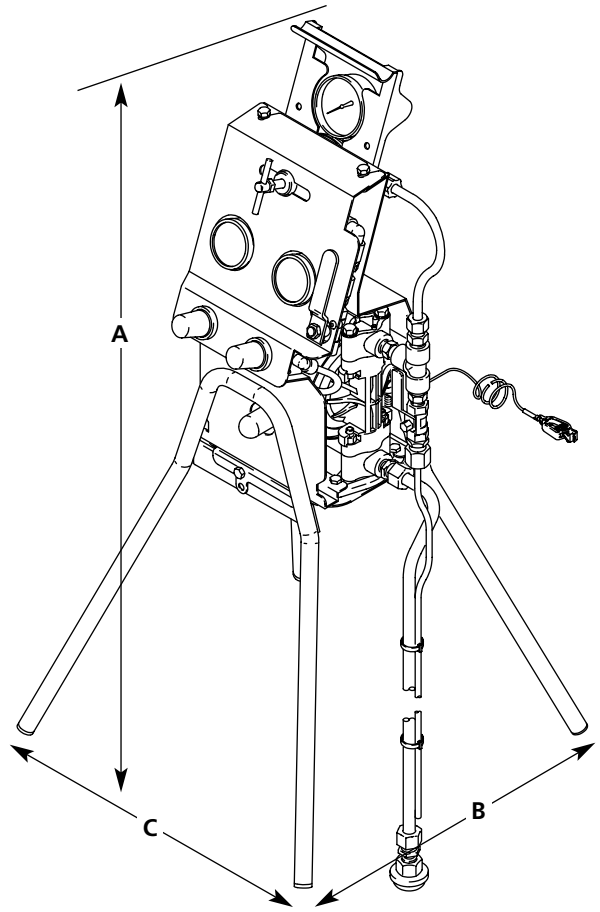

A Height	B Depth	C Width
34.0 in. (864 mm)	16.5 in. (419 mm)	17.5 in. (445 mm)

# Dimensions

## Pail-Mounted Package

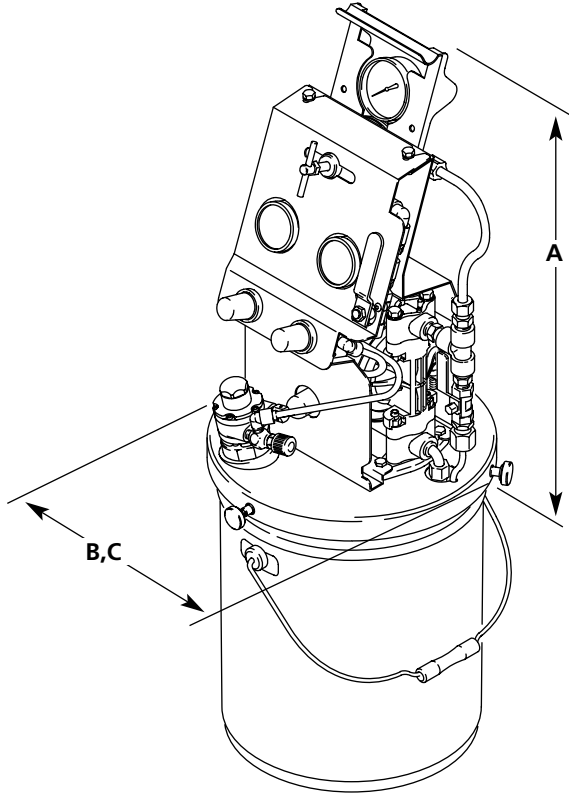

A Height	B Depth	C Width
21.0 in. (533 mm)	12.3 in. (312 mm)	12.3 in. (312 mm)

## Wall-Mounted Package

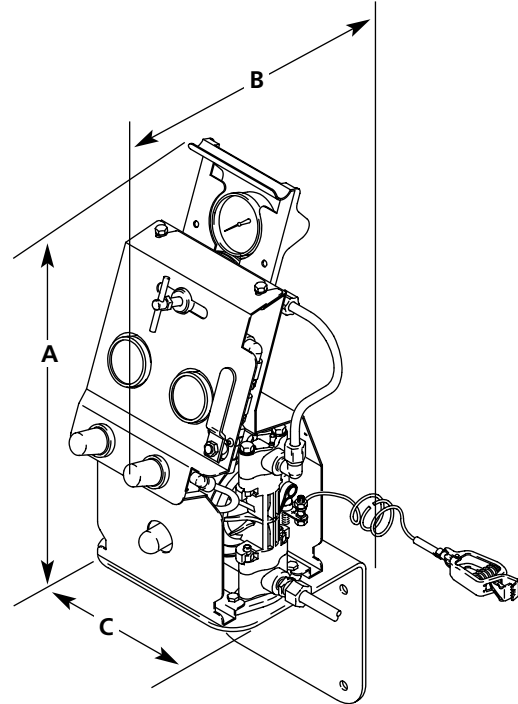

A Height	B Depth	C Width
21.0 in. (533 mm)	11.5 in. (292 mm)	9.0 in. (229 mm)

## Dimensions

### Heavy Duty Cart-Mounted Package

Heated cart unit has original design pump assembly.

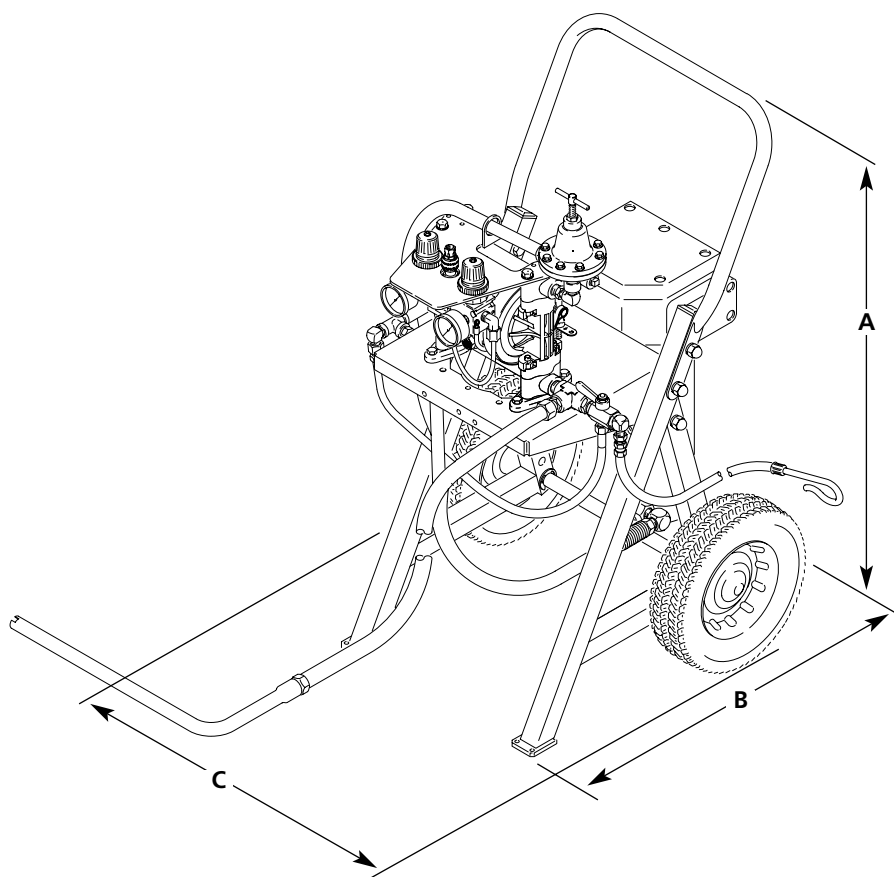

<b>A</b> <b>Height</b>	<b>B</b> <b>Depth</b>	<b>C</b> <b>Width</b>
56 in. (1421 mm)	29.5 in. (748 mm)	25 in. (634 mm)

# Selection Guide for Delta/PRO Spray Packages

The following items are available only in North America, South America and Southeast Asia.

	Corrosion Resistant* Construction Part No.	Bare Pump only (B)	Heavy-Duty Cart Mount	Wall Mount	Pail Mount	Light Duty Cart	Stand Mount	Heaters (voltage)	Fluid Regulator (psi)**	Agitator	Suction Kit (D=Drum)	Circulation Kit	Recirculation Manifold	Surge Tank	Air Hose (25 ft., 7.6 m)	Fluid Hose (25 ft., 7.6 m)	Applicator	Instruction Manual
<b>Pressure Pot</b>																		
SST 5 gal. (18.9 liter)	• 237-409														•	•	Delta AS	308-455
	• 237-413														•	•	Delta HVLP	308-456
<b>Husky 307</b>																		
	• 240-321			•				100	•						•	•	Delta AS	308-822
	• 240-322			•				30	•						•	•	Delta HVLP	308-822
	• 240-323	•		•				100	•									308-822
	• 240-324			•				100	•						•	•	PRO 3500	308-822
	• 240-325			•				100	•						•	•	PRO 4500	308-822
	• 240-237			•					•					•	•	•	Delta AS	308-822
	• 240-238			•					•					•	•	•	Delta HVLP	308-822
	• 240-239	•		•					•					•				308-822
	• 240-331			•					•	•				•			Delta AS	308-822
	• 240-332			•					•	•				•	•	•	Delta HVLP	308-822
	• 240-333	•		•					•	•				•	•	•		308-822
	• 240-337			•				100	•	•					•	•	Delta AS	308-822
	• 240-338			•				30	•	•					•	•	Delta HVLP	308-822
	• 240-339	•		•				100	•	•								308-822
	• 240-340			•				100	•	•					•	•	PRO 3500	308-822
	• 240-341			•				100	•	•					•	•	PRO 4500	308-822
	• 240-349			•				100	D						•	•	Delta AS	308-845
	• 240-350			•				30	D						•	•	Delta HVLP	308-845
	• 240-351	•		•				100	D									308-845
	• 240-352			•				100	D						•	•	PRO 3500	308-845
	• 240-353			•				100	D						•	•	PRO 4500	308-845
	• 240-361			•					D					•	•	•	Delta AS	308-845
	• 240-362			•					D					•	•	•	Delta HVLP	308-845
	• 240-363	•		•					D					•				308-845

\*Corrosion resistant or stainless steel 304 or better, all wetted areas. All other models SevereDuty™

\*\*100 psi (0.7 MPa, 7 bar)  
30 psi (0.2 MPa, 2 bar)

# Selection Guide for Delta/PRO Spray Packages

The following items are available only in North America, South America and Southeast Asia.

Corrosion Resistant* Construction Part No.	Bare Pump only (B)	Heavy-Duty Cart Mount Wall Mount	Pail Mount	Light Duty Cart Stand Mount	Heaters (voltage)	Fluid Regulator (psi)**	Agitator	Suction Kit (D=Drum)	Circulation Kit	Recirculation Manifold	Surge Tank	Air Hose (25 ft., 7.6 m)	Fluid Hose (25 ft., 7.6 m)	Applicator	Instruction Manual
• 240-367				•		100	•					•	•	Delta AS	308-846
• 240-368				•		30	•					•	•	Delta HVLP	308-846
• 240-369				•		100	•					•	•	PRO 3500	308-846
• 240-370				•		100	•					•	•	PRO 4500	308-846
• 240-379				•			•			•	•	•	•	Delta AS	308-846
• 240-380				•			•			•	•	•	•	Delta HVLP	308-846
• 240-385				•		100	•					•	•	Delta AS	308-821
• 240-386				•		30	•					•	•	Delta HVLP	308-821
• 240-387				•		100	•					•	•	PRO 3500	308-821
• 240-388				•		100	•					•	•	PRO 4500	308-821
• 240-397				•			•			•	•	•	•	Delta AS	308-821
• 240-398				•			•			•	•	•	•	Delta HVLP	308-821
237-410	•					120 BPR	•	•	•			•	•	Delta AS	308-448
237-414	•					120 BPR	•	•	•			•	•	Delta HVLP	308-451
237-417	•					120 BPR	•	•	•			•	•	PRO 3500	308-454

\*Corrosion resistant or stainless steel 304 or better, all wetted areas. All other models SevereDuty™

\*\*100 psi (0.7 MPa, 7 bar)  
30 psi (0.2 MPa, 2 bar)

## **Accessories**

### **240-440 Fluid Filter**

Includes fluid filter, tubing and connector.

### **226-086 Pail Cover and Agitator Kit**

Includes pail cover and single-blade agitator assembly (CS and aluminum).